

DIM.	TOL.
5mm DOWN	±0.2
5~20mm	±0.3
20~40mm	±0.4
40~60mm	±0.5
60~100mm	±0.8
100mm UP	±1.0

REVISIONS			
REV	DESCRIPTION	DATE	BY

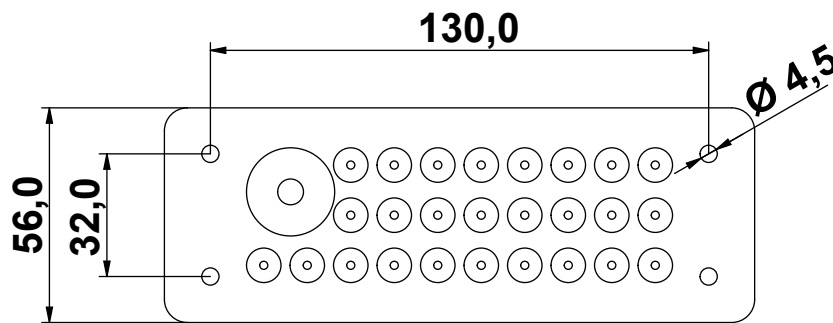
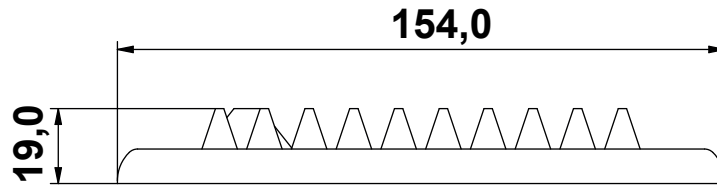

WORKING TEMPERATURE: -40°C ~ +90°C

CUTOUT: 112,0 x 36,0 mm

IP RATING: IP55

FLAMMABILITY: V0 (UL94)

NO. OF CABLE LEAD-THROUGHS: 27

MAX CABLE Ø 20,0 mm

MIN CABLE Ø 3,0 mm

INSTALLATION RANGE (DIAMETER PER CABLES):

- 26 x 3 - 6 mm
- 1 x 10 - 20 mm

				TITLE CABLE ENTRY PLATE IP55	
				MATERIAL TPE V0 (UL94)	DATE 23/02/2024
				DRAWN E.B.	
PART NUMBER 18716PS019005		DRAWING NUMBER 24.02.23.18716.0.E		COLOR RAL 9005	CHECK
SIZE A4	SCALE NTS	UNIT mm.	REV A	UNLESS OTHERWISE SPECIFIED TOLERANCE SEE ABOVE	APPROVED