

DIM.	TOL.
5mm DOWN	±0.2
5~20mm	±0.3
20~40mm	±0.4
40~60mm	±0.5
60~100mm	±0.8
100mm UP	±1.0

REVISIONS			
REV	DESCRIPTION	DATE	BY

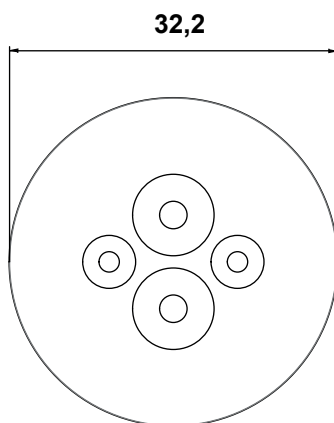
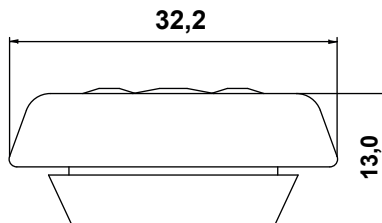

**WORKING TEMPERATURE: -40°C ~ +100°C**  
**SIZE: M20**  
**CUT-OUT: Ø20,5**  
**IP RATING: IP65**  
**FLAMMABILITY: V0 (UL94)**  
**PLATE THICKNESS: 1,0 - 4,0mm**  
**INSTALLATION RANGE (Ø):**  
 - 2 x 1 - 8,0 mm  
 - 2 x 1 - 4,5 mm

				TITLE <b>ROUND CABLE ENTRY PLATE IP65</b>	
				MATERIAL TPE V0 (UL94)	DATE 26/06/2024
PART NUMBER 18718PS117035				DRAWING NUMBER 24.06.26.18718.0.E	
				COLOR RAL 7035	CHECK
SIZE A4	SCALE NTS	UNIT mm.	REV A	UNLESS OTHERWISE SPECIFIED TOLERANCE SEE ABOVE	APPROVED